

CAT 5e Shielded Connector

APPLICATION

Leviton CAT 5e Shielded Connectors protect critical data from EMI (electromagnetic interference) and RFI (radio frequency interference). This makes them part of a complete CAT 5e Shielded System ideal for use in healthcare, manufacturing, casinos and other environments where EMI/RFI may be a concern. Leviton's Shielded Solution is Rockwell Automation Encompass™ Approved.

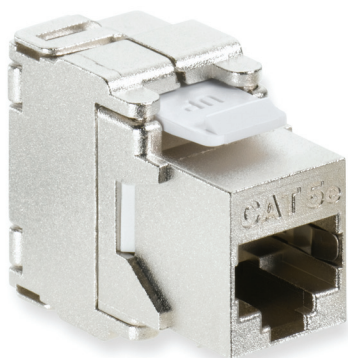

SPECIFICATION

CAT 5e shielded connector shall protect data from EMI/RFI and be encased in a die-cast housing with a wide angle, hinged design that allows easy access for termination. The connector shall allow termination without a 110 punch down tool. The connector shall include T568A and T568B universal color codes.

FEATURES

- Shielding provides EMI/RFI protection and data security
- Connector features robust die-cast housing
- Unique design requires no punch-down tool
- Connector incorporates a wide angle, hinged design for easy access / termination
- Rockwell Encompass™ approved

DESIGN CONSIDERATIONS

- Can be used to terminate all types of shielded cable
- Use flush cut trimmers to remove exposed conductors prior to termination
- In a QuickPort® wallplate, connectors should be mounted horizontally (side-by-side)
- When installed vertically in a QuickPort wallplate, product dimensions necessitate a blank space between connectors
- Utilize tie wrap (included) to ensure contact between drain wire and shield to connector

STANDARDS COMPLIANCE

- TIA-568-B.2 CAT 5e
- FCC part 68
- IEC 60603-7
- Intertek (ETL) 3rd party verification

PHYSICAL SPECIFICATIONS

Dimensions: See page two

WARRANTY INFORMATION

For a copy of Leviton product warranties, visit www.leviton.com.

ELECTRONIC FILES

For CAD files, Typical specs, or Dimensional Line Art. (.DXF, .DWG, MS-DOS.eps or .TXT), visit www.leviton.com.

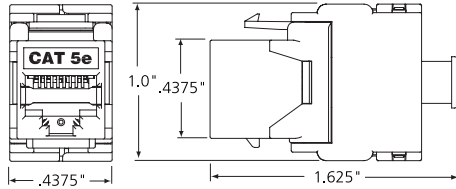

5S180-SH5

| PART NUMBERS | |
|---------------------------|-----------------|
| Description | Part No. |
| CAT 5e Shielded Connector | 5S180-SH5 |

| QUICKPORT® WALLPLATE / SHIELDED CONNECTOR COMPATIBILITY GUIDE | |
|--|--|
| QuickPort Single-Gang Wallplates | Number of Shielded Connectors Supported |
| 41080/42080, 1-Port | 1 |
| 41080/42080, 2-Port | 1 |
| 41080/42080, 3-Port | 2 |
| 41080/42080, 4-Port | 2 |
| 41080/42080, 6-Port | 4 |
| QuickPort Single-Gang Stainless Steel Wallplates | Number of Shielded Connectors Supported |
| 43080, 1-Port | 1 |
| 43080, 2-Port | 2 |
| 43080, 3-Port | 2 |
| 43080, 4-Port | 4 |
| 43080, 6-Port | 4 |
| QuickPort Single-Gang Angled Wallplates | Number of Shielded Connectors Supported |
| 41081/42081, 2-Port | 2 |
| 41081/42081, 4-Port | 2 |



| | | | | | |
|--|--|--|---|--|---|
| Leviton Network Solutions 2222 - 222nd St. SE Bothell, WA 98021-4416 tel 1-800-824-3005 tel +1-425-486-2222 appeng@leviton.com www.leviton.com | Asia / Pacific T +1.631.812.6228 E infoasean@leviton.com | Canada T +1.514.954.1840 E pcservice@leviton.com | Caribbean T +1.954.593.1896 E infocaribbean@leviton.com | China T +852.2774.9876 E infochina@leviton.com | Colombia T +57.1.743.6045 E infocolombia@leviton.com |
| | Europe T +33.6.8869.1380 E infoeurope@leviton.com | India / SAARC T +91.80.4322.5678 E infoindia@leviton.com | Mexico T +52.55.5082.1040 E lsamarketing@leviton.com | Middle East & Africa T +971.4.886.4722 E lmeinfo@leviton.com | South Korea T +82.2.3273.9963 E infokorea@leviton.com |